

INSTALLATION INFORMATION

1. Avoid torque.

Do not twist the hose assembly during installation when aligning the bolt holes in a flange or in mating up pipe threads. The utilization of lap joint flanges or pipe unions will minimize this condition. It is recommended that two wrenches be used in making the union connection: one to prevent the hose from twisting and the other to tighten the coupling.

2. Prevent out-of-place flexing in an installation.

Always install the hose so that the flexing takes place in only one plane – this being the plane in which the bending occurs.

3. Avoid over bending.

The repetitive bending of a hose to a radius smaller than the radius listed in the specification tables for corrugated hose will result in early hose failure. Always provide sufficient length to prevent over-bending and to eliminate strain on the hose.

4. Avoid careless handling of the hose assembly.

Always lift or carry metal hose to prevent abrasion damage particularly to braided corrugated hose. Store metal hose assemblies away from areas where it can be subjected to spillage, corrosive fumes or sprays, weld splatter, etc.

5. Always support the piping.

A piping system which utilizes metal hose to absorb movement must be properly anchored and/or guided. Always support the piping to prevent excessive weight from compressing the hose and relaxing the braid tension.

Do...

- Follow any printed instructions included with the flexible connector.
- Follow industry–recommended practices and use care in handling and installing flexible connector.
- Install flexible connectors so that the bend is as close to the center of the connector as possible.
- Observe the minimum bend radius as specified by the connector manufacturer.
- Trial-fit threaded connections by hand, unmake and then make permanent.
- Use a flexible connector of proper length to suit the installation.
- Only wrench on the fitting hex flats as provided.
- Design the installation to allow for ground movement after installation, such as settling or frost heave.
- Install the proper length connector to allow a 2" straight run of hose at each end fitting.
- Use pipe wrenches on both mating hexes to avoid twisting the hose.
- Keep hose free from all objects and debris.
- Handle and store connectors carefully prior to installation.
- Check for leaks before covering the installation.
- Install in such a manner that the connector can be removed.
- Make sure the pressure rating and flow rating of connector is not exceeded.

Don't...

- Apply a wrench to a hose, collar or assembly.
- Twist hose assemblies during installation or when aligning the bolt holes in a flange or when making up pipe threads.
- "Pre-flex" a flexible connector to limber it up.
- Over-bending could cause damage and result in leakage.
- Over-bend a flexible connector. A 45°–90° bend should be sufficient to install any flexible connector.
- Install a flexible connector with the bend next to the end fittings. This could cause damage and result in leakage.
- Lay the flexible connector on rocks or objects which could puncture the hose and cause leakage.
- Attempt to stretch or compress a flexible connector to fit an installation.
- Restrict flexibility by allowing connector to come into contact with other components or equipment during installation.

UNISOURCE^{—MFG.}

1-800-234-2566

8040 NE 33rd Drive / Portland, OR 97211 (503) 281-4673 Fax (503) 281-5845

INSTALLATION INFORMATION

In plane lateral offset installation.

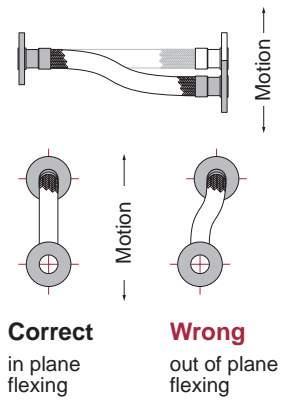

Avoid sharp bends.

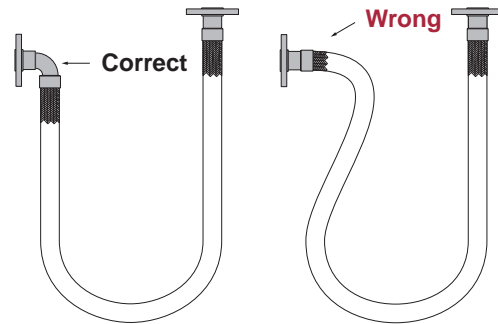

In plane traveling loop installation.

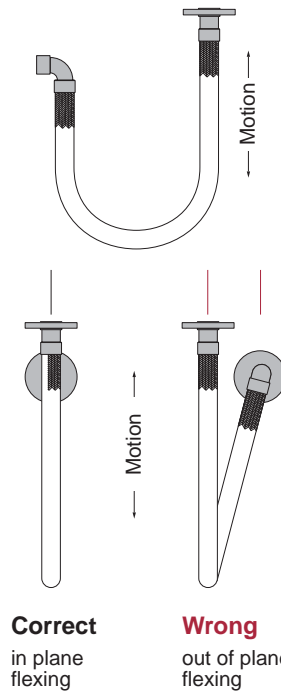

Provide support.

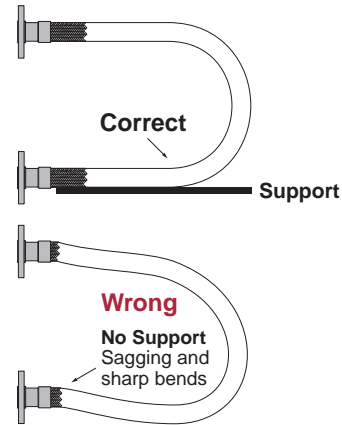

Do not extend or compress axially.

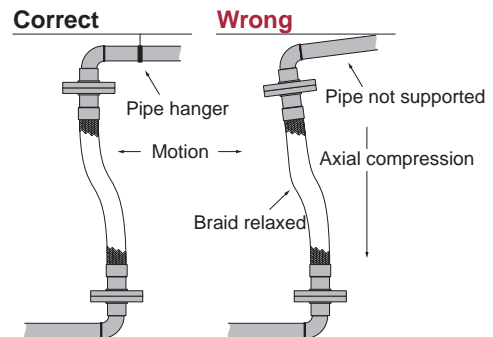

Avoid over bending

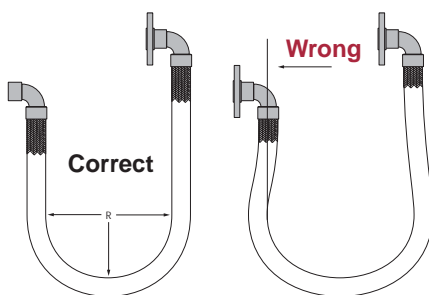

UNISOURCE MFG.

1-800-234-2566

8040 NE 33rd Drive / Portland, OR 97211 (503) 281-4673 Fax (503) 281-5845